PDUeX
GROUP

PDUeX Control room Solutions
Innovators in Data, Control Room & Power Management

Display screen arm

Big arms desktop mounted



Bearing range : 3-12kg

Support VESA hole spacing(mm) : 75x75 100x100

Suitable for display size : 22-35 inches

Material : aluminum profile / cold rolled steel sheet
ABS environmental protection plastic

According to the color style of the console, pduex has three color display arms.



Black

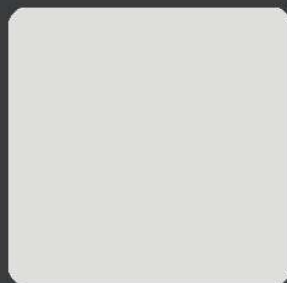

Silvery



White



www.tuv.com
ID 1419 0775 88



USB port for charging

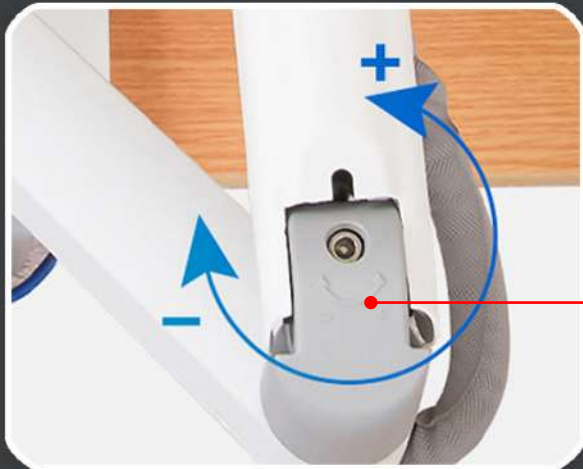
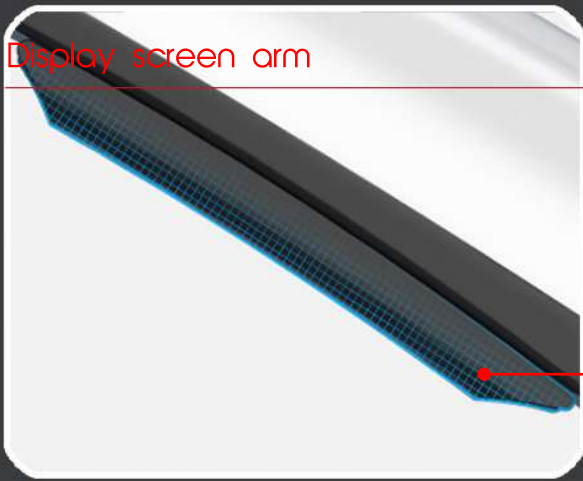

Detachable cable trough

The cantilever pressure is adjustable.

Barometric hover
3-12kg dynamic weighing
Stepless regulation is more stable.
After 50000 fatigue tests,
it can be safely used for 10 years.



Charging point



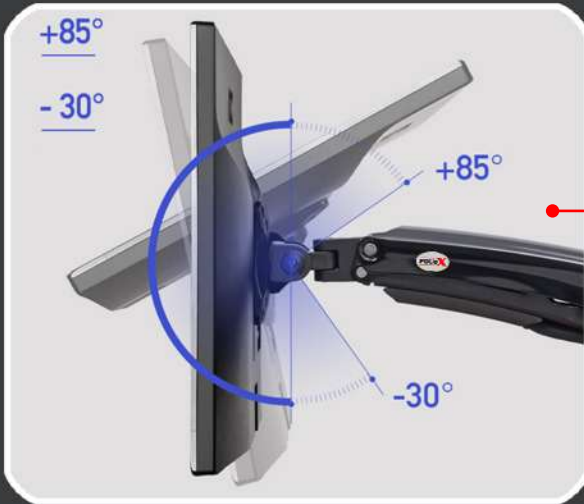

Adjust the tilt angle, change it several times a day, and relax your shoulders.

VESA installation standard

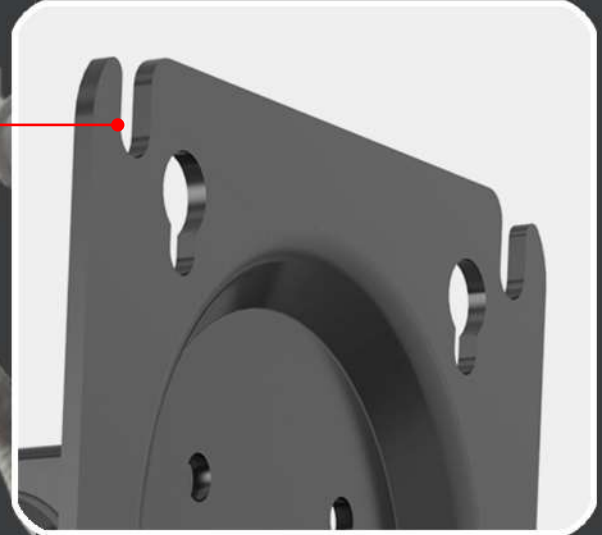

According to the user's browsing content, the horizontal and vertical screens can be easily switched.



non-slip mat
Protect the desktop from scratches

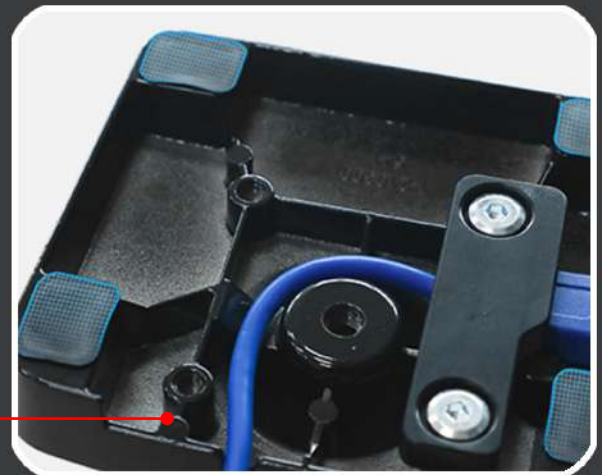

Joint rotation, three-axis rotation, free adjustment

Follow the line of sight, adjust the angle at any time, and adjust the three joints at will.

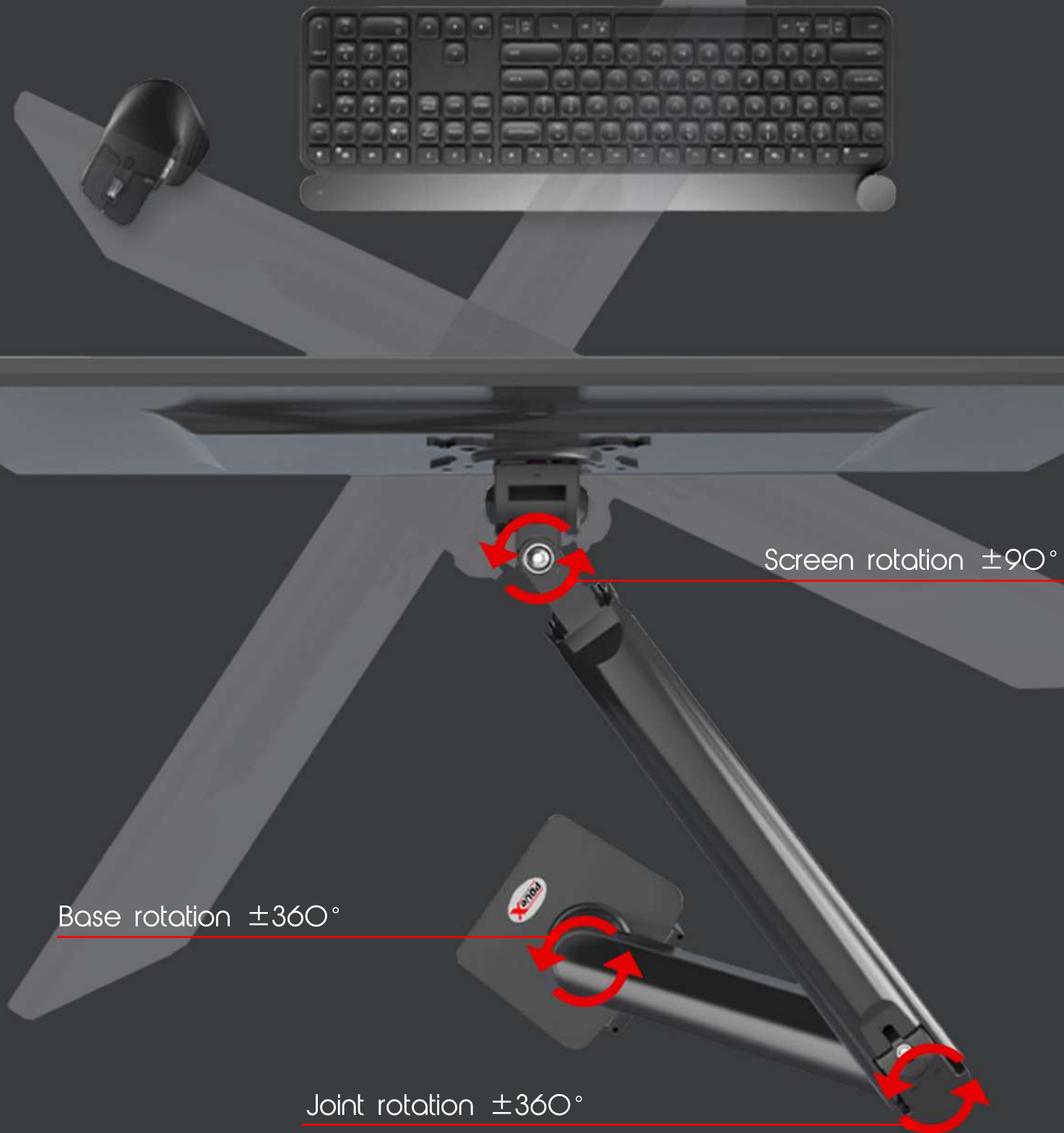

530mm up and down height, with large screen display, to provide you with a better office experience.

Up and down 530mm



650mm stretch range, to meet people's visual distance requirements for different scenes, visual comfort.

Stretching distance 650mm



Single and dual display arms give the console more options.

